

One Way Acme Thread Slide Table

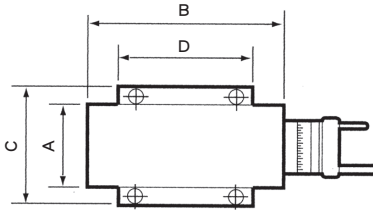

- Material : FC-30
- Precision : $\pm 0.01 / 100\text{mm}$

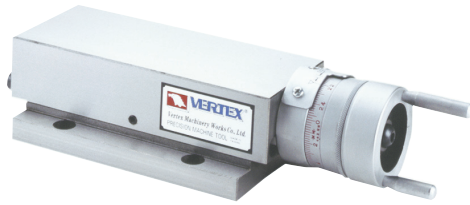
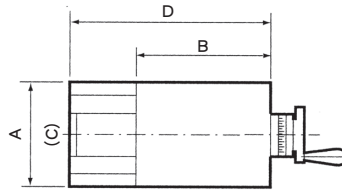
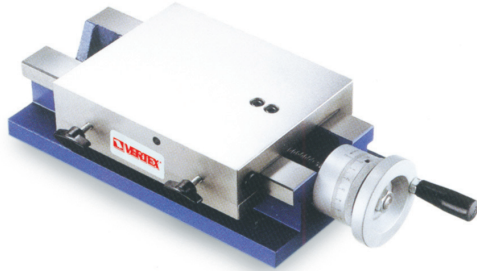

ST-75 ST-100 ST-125

STA-160 STA-165 STA-200
STA-205 STA-300 STA-305

- Material : FC-30
- Precision : $\pm 0.01 / 100\text{mm}$
- FEATURE : The sliding surfaces are treated by heat-treatment & precision ground.

Specifications

Unit: mm

ORDER NO.	A x B Table surface	C x D Base area	Stroke	Toral height	Dial graduation	WEIGHT kgs	CODE NO.
ST-75	75 x 180	105 x 157	75	60	2.5 x 0.02	6.5	7002-540
ST-100	100 x 235	140 x 160	100	70	2.5 x 0.02	9.5	7002-541
ST-125	125 x 300	165 x 255	125	80	4.0 x 0.02	18.5	7002-542
STA-160	160 x 200	160 x 300	100	90	4.0 x 0.02	20	7002-543
STA-165	160 x 200	160 x 400	200	90	4.0 x 0.02	23.0	7002-544
STA-200	200 x 300	200 x 400	100	120	4.0 x 0.02	38.0	7002-545
STA-205	200 x 300	200 x 600	300	120	4.0 x 0.02	50.5	7002-546
STA-300	300 x 350	300 x 500	150	188	4.0 x 0.02	98.0	7002-547

Vertical Dovetail Slide Table

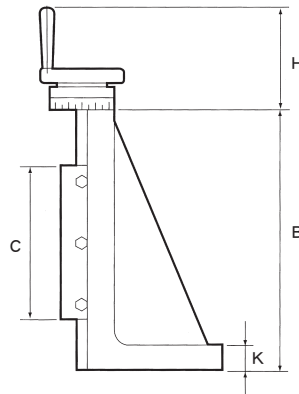
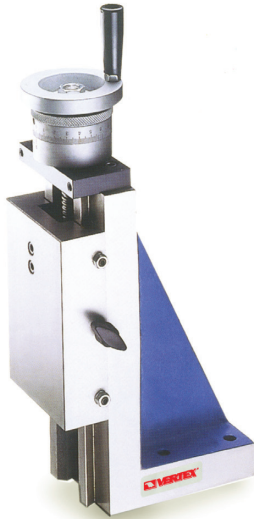

- Material : FC-30
- Precision : $\pm 0.01 / 100\text{mm}$
- FEATURE : The sliding surfaces are treated by heat-treatment & precision ground
Dial graduation 4.0 x 0.02mm

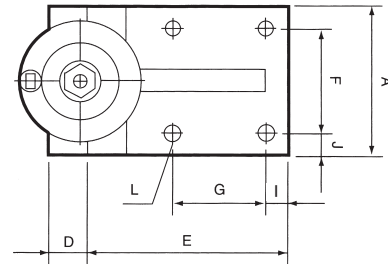

Specifications

Unit: mm

ORDER NO.	A	B	C	D	E	F	G	H	I	J	K	L	Weight kgs	CODE NO.
SE-100	100	255	150	35	130	70	60	120	30	15	26	Ø10 x 4	15	7002-560
SE-150	150	385	200	40	185	110	90	120	20	20	35	Ø13 x 4	35	7002-561
SE-200	200	510	250	60	240	160	140	135	20	20	40	Ø17 x 4	67	7002-562
SE-250	250	600	300	60	280	200	160	140	25	25	40	Ø17 x 4	115	7002-563